



Board Meeting

15 August 2016

Green Bay Area Public Schools
Facilities Master Planning

pra
PLUNKETT RAYSICH
ARCHITECTS, LLP

introduction

Master Plan Update

1. Enrollment & Capacity
2. Modern Learning Spaces
3. Process: Next Steps



Enrollment

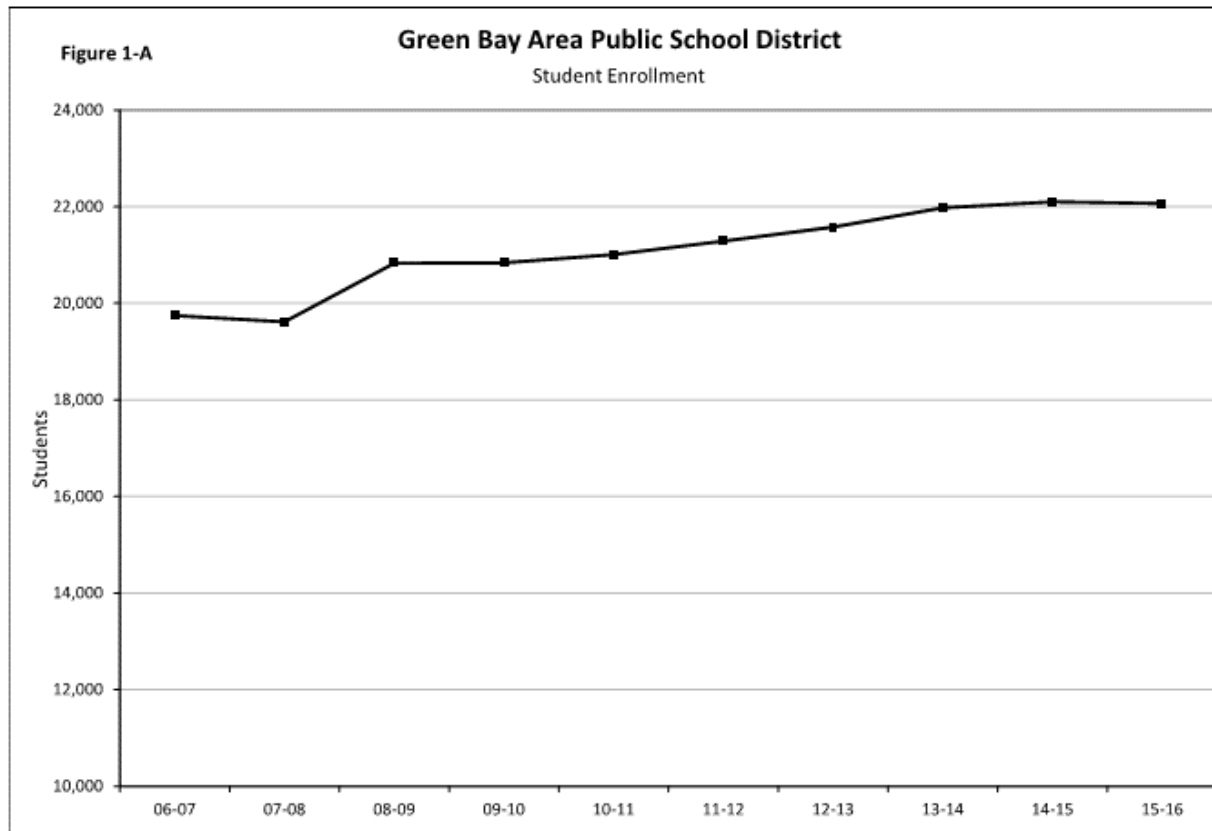

Historic District Enrollment Trend

Enrollment

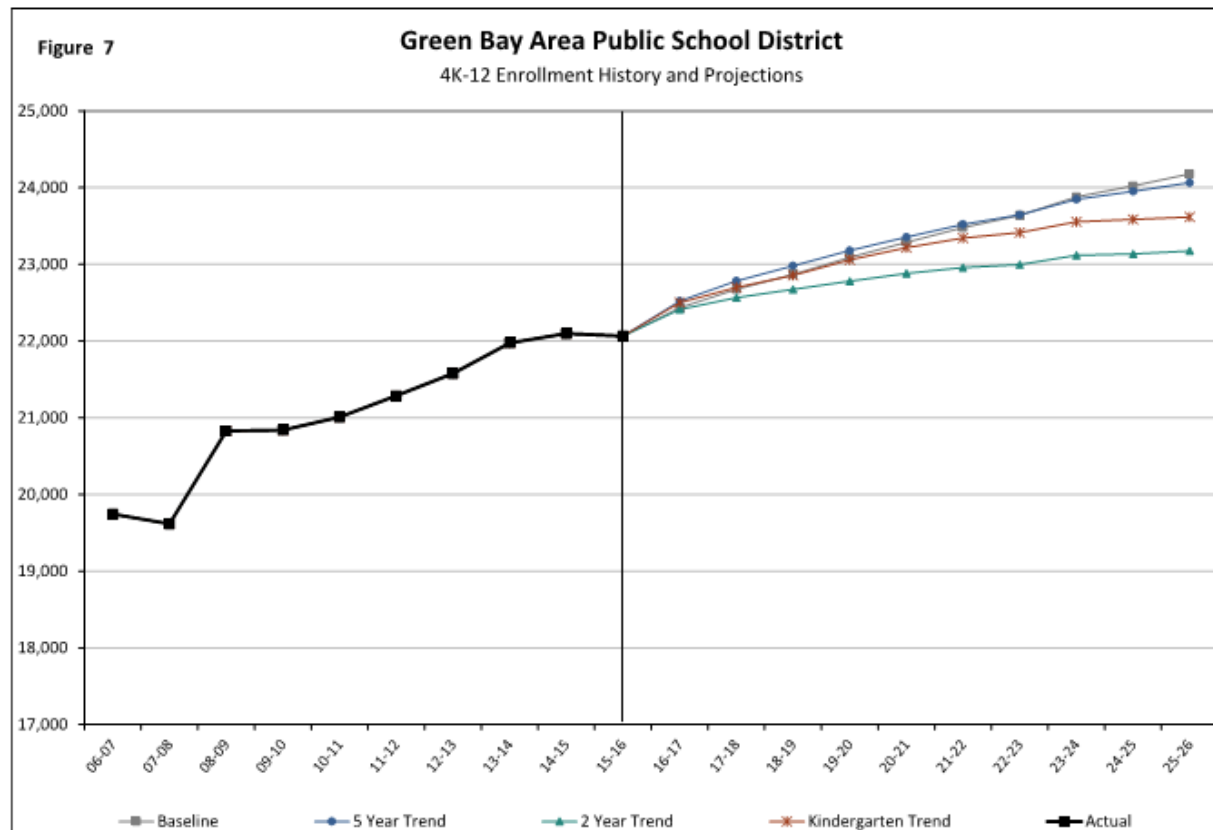

Projected District Enrollment Trend

Enrollment

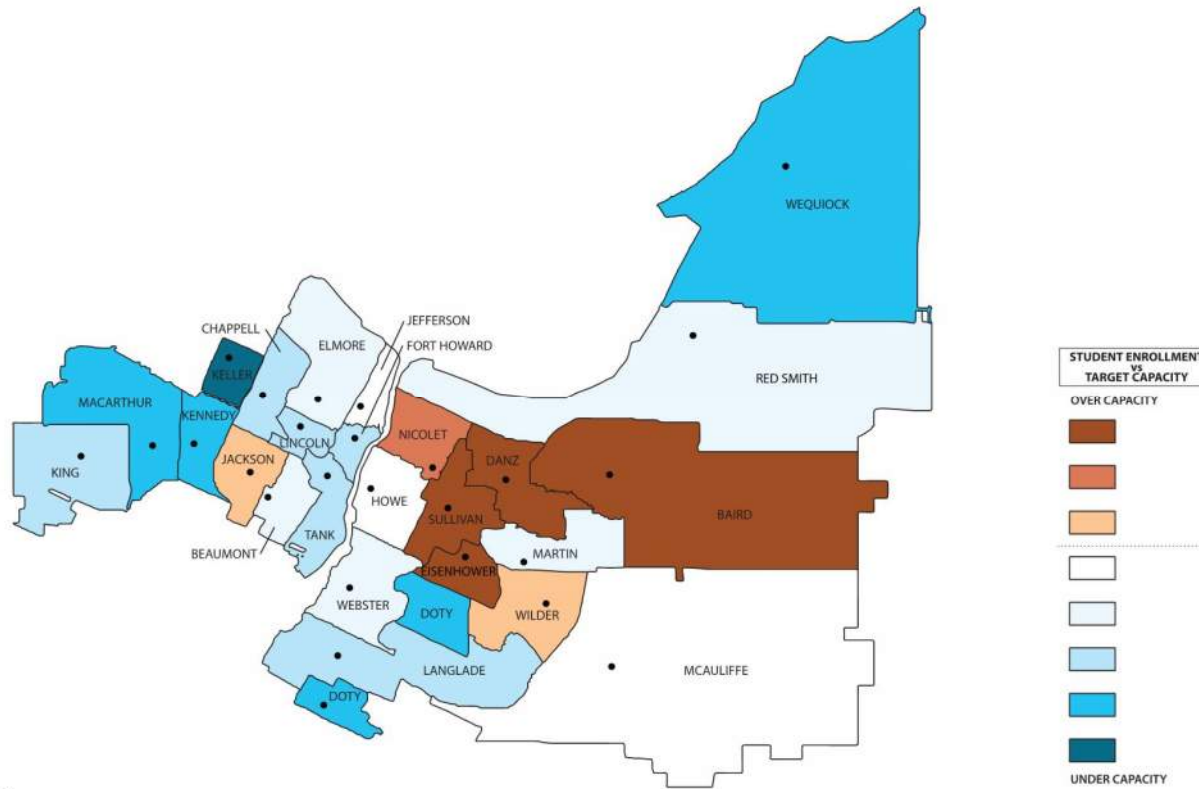

Projected Elementary Capacity – 2020/21

Enrollment

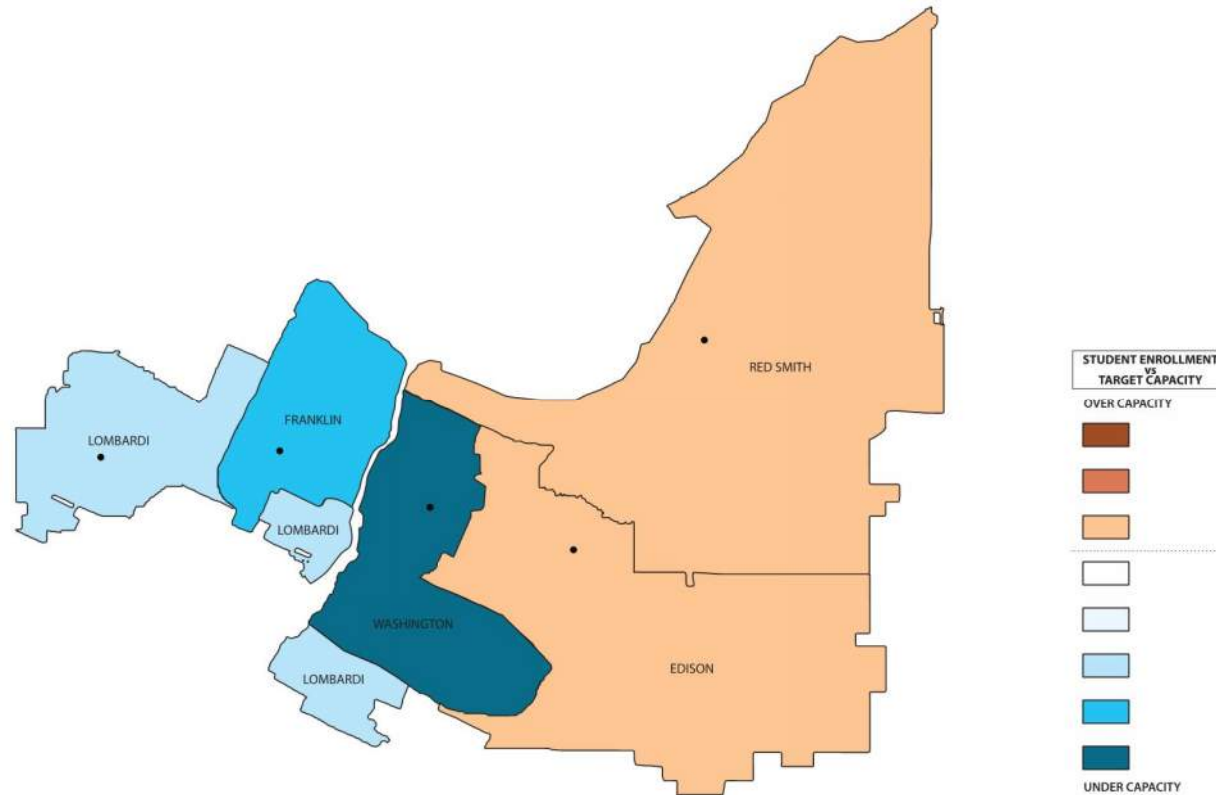

Projected Middle School Capacity – 2020/21

Enrollment

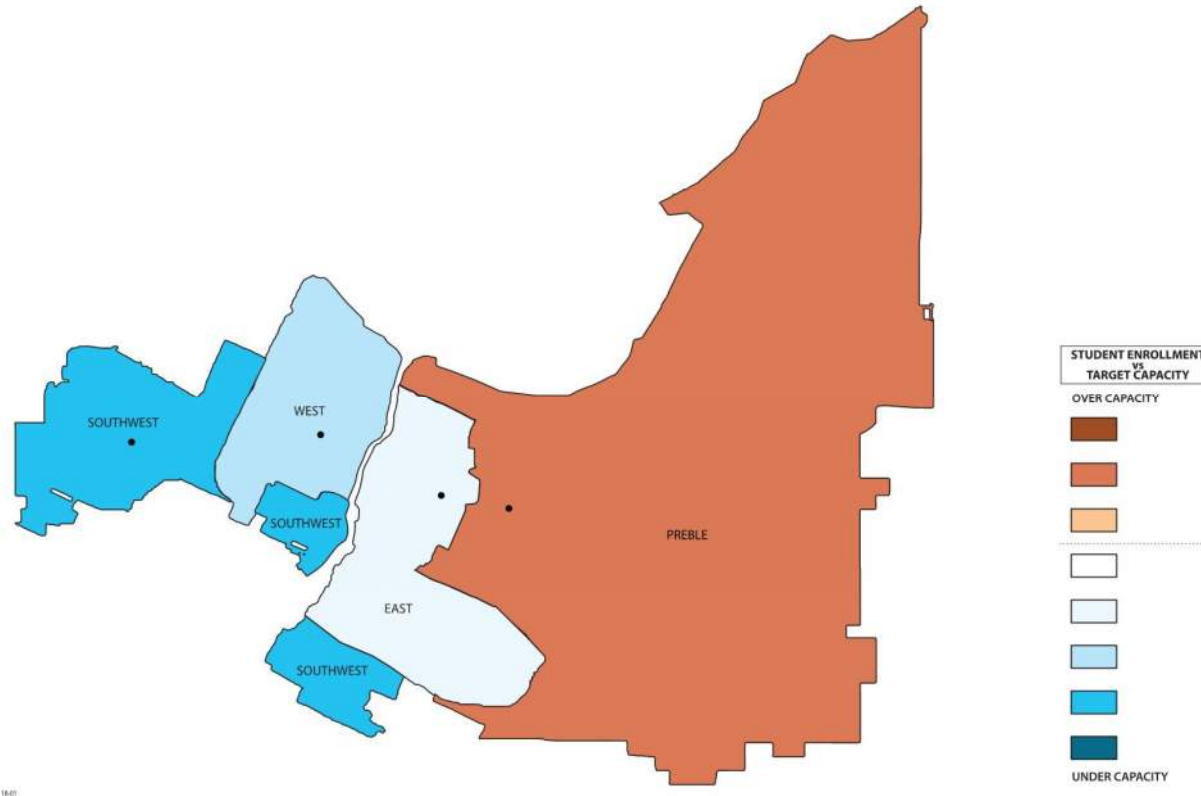

Projected High School Capacity – 2020/21

District Master Plan

Modern Learning Environments

creativity | collaboration | dedication

evolution of learning

A Brief History of School Design

1920's – Industrial Model

- Schools designed to reflect modern thinking
- Standardized thinking and teaching
- Efficient – students trained for a repetitious industrial world
- Not flexible



<http://adamschristianschool.org/about/history/>

evolution of learning

A Brief History of School Design

1960's – Experiment in Open Concept

- Movement began in the UK
- Reaction to standardized teaching and learning
- Thought was students learned better outside of the “box”
- Multi-age / multi-instructor organization
- Building design did not synch with teaching and learning



evolution of learning

1990s classroom



evolution of learning

A Brief History of School Design

2000's – Student Centered Learning

- Digitally connected world transforms education
- Students learn anytime, anywhere
- Technology allows for greater individualization
- Spaces become multipurpose and more flexible
- Greater variety of learning environments available



student-centered learning

Various Settings and Context

- Different places for learning
- Self learning vs. organized learning
- Multiple learning styles
- Flipped classroom



transforming the learning environment

Current Space Configuration

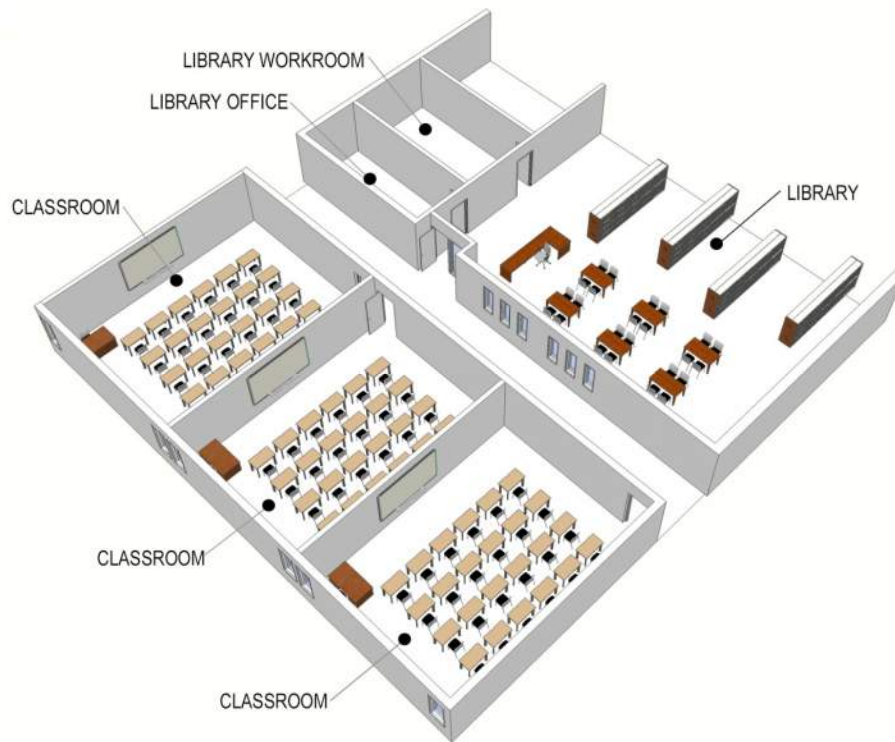

Reconfigured Space

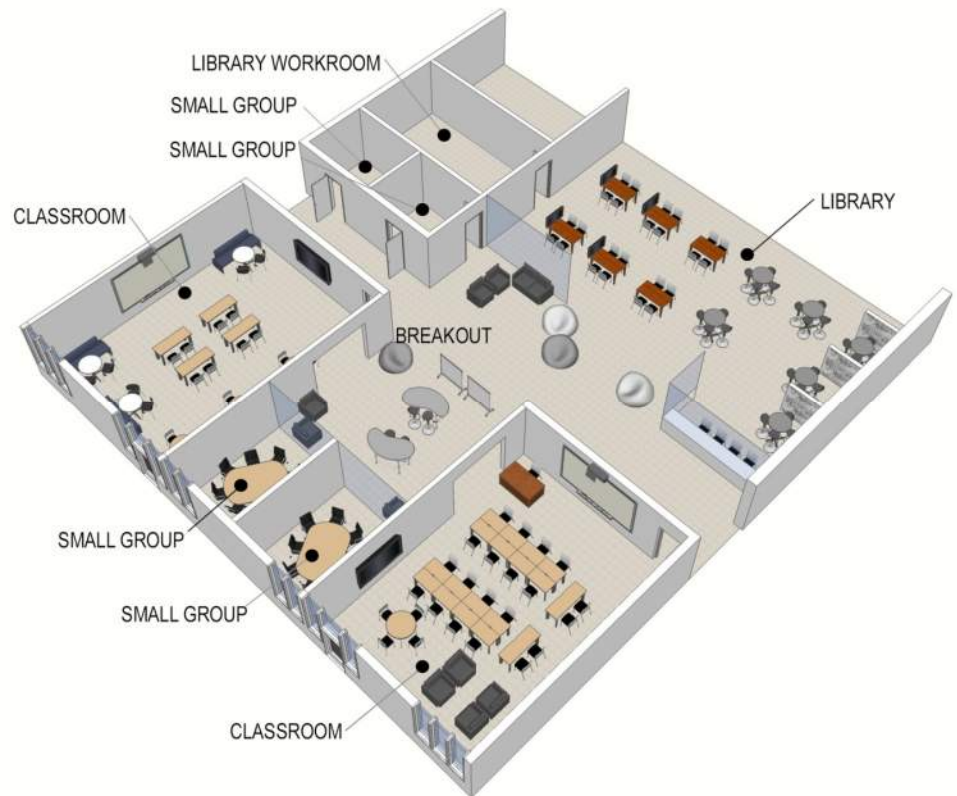

transforming the learning environment

Breakout Areas/Transition Spaces

- Enable team teaching/learning
- Enable project-based learning
- May be used by small or large groups
- Enrichment spaces



District Master Plan

Process: Next Steps

creativity | collaboration | dedication

Conclusion

Next Steps:

1. Upcoming Community Engagement Sessions
 - Sept. 13, West HS, 6:30 p.m.
 - Sept. 15, Preble HS, 6:30 p.m.
 - Sept. 20, Southwest HS, 6:30 p.m.
 - Sept. 26, East HS, 6:30 p.m.
2. Facility Task Force – October 2016
3. Community Survey – November 2016
4. Completed Facility Master Plan – December 5, 2016

questions and
answers



creativity | collaboration | dedication